

DISASSEMBLY

NOTICE:

When using a vise, do not overtighten it.

1. REMOVE NO.2 LOWER COVER

Remove the 2 nuts.

2. REMOVE INTERMEDIATE SHAFT ASSEMBLY

(a) Place matchmarks on the shaft assembly and main shaft assembly.

(b) Remove the bolt.

(c) Remove the thrust stopper.

3. REMOVE NO.2 LOWER COVER

4. REMOVE TRANSPONDER KEY COIL WITH KEY CYLINDER LAMP ASSEMBLY

Remove the screw.

5. REMOVE KEY CYLINDER LAMP ASSEMBLY

Remove the lamp assembly from the key coil.

6. REMOVE CONNECTOR BRACKET

Remove the bolt.

7. REMOVE STEERING COLUMN PROTECTOR NO.1

Remove the bolt.

8. REMOVE TURN SIGNAL BRACKET

Remove the 3 bolts.

9. REMOVE POWER TILT MOTOR

(a) Using a hexagon wrench, remove the support stopper bolt.

(b) Remove the stopper spring and stopper No.1.

(c) Using a hexagon wrench, remove the 2 tilt steering bolts.

(d) Using a screwdriver, remove the 2 E-rings.

(e) Remove the 2 support stopper bolt bushings from the motor.

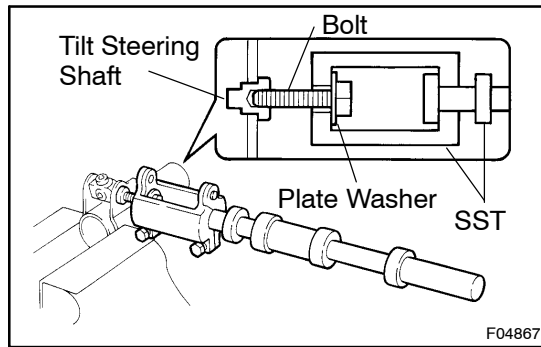
**10. REMOVE ADJUSTING NUT NO.1**

- (a) Set SST, a plate washer (36 mm outer diameter) and bolt (10 mm normal diameter, 1.25 mm pitch, 50 mm length), as shown.

SST 09910-00015 (09911-00011, 09912-00010)

Reference:

Plate washer 90201-10201

Bolt 91111-51050

- (b) Remove the 2 tilt steering shafts by using the sliding hammer on SST.
- (c) Remove the 2 support stopper bolt bushings from the adjusting nut No.1.

11. REMOVE POWER TELESCOPIC MOTOR

- (a) Remove the 2 bolts.
- (b) Remove the telescopic steering column cable.

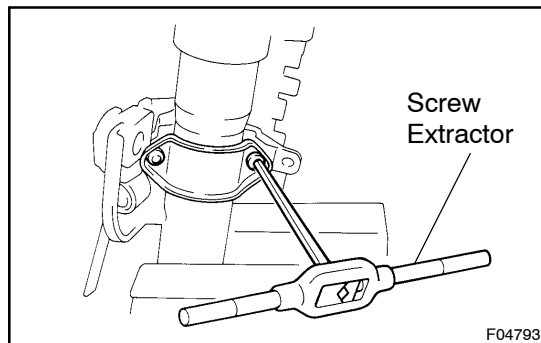
**12. REMOVE COLUMN UPPER BRACKET AND COLUMN UPPER CLAMP**

- (a) Using a centering punch, mark the center of the 2 tapered-head bolts.
- (b) Using a 3 – 4 mm (0.12 – 0.16 in.) drill, drill into the 2 bolts.
- (c) Using a screw extractor, remove the 2 bolts.
- (d) Using a hexagon wrench, remove the 2 telescopic lever lock bolts.
- (e) Remove the 2 telescopic steering wedge lock springs and 2 steering lock wedges.

13. REMOVE COLUMN TUBE SUPPORT

- (a) Remove the bolt.
- (b) Remove the tube support with lower tube attachment.
- (c) Remove the tube attachment from the tube support.

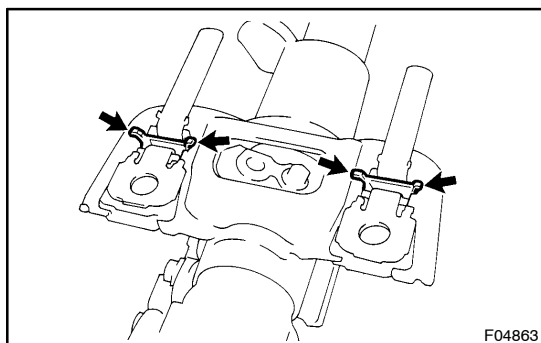
**14. REMOVE 2 ENERGY ABSORBING PLATES**

- (a) Using pliers, remove the energy absorbing clip.
- (b) Remove the energy absorbing plate and energy absorbing guide.

15. REMOVE TELESCOPIC STEERING SLIDER SUPPORT

Remove the 2 bolts.

16. REMOVE TELESCOPIC STEERING BUSHING**17. REMOVE TELESCOPIC STEERING SLIDER****18. REMOVE TELESCOPIC STEERING SCREW**

Remove the nut, 4 energy absorber cushions, 2 bearings and steering screw.

19. REMOVE COLUMN UPPER TUBE ASSEMBLY

- (a) Using a screwdriver, remove the snap ring.
- (b) Using a hexagon wrench, remove the 2 tilt steering bolts.
- (c) Remove the column upper tube sub-assembly from the column tube.
- (d) Remove the 2 support stopper bolt bushing from the column upper tube assembly.
- (e) Remove the column upper tube assembly.
- (f) Remove the 3 bushings from the column tube.

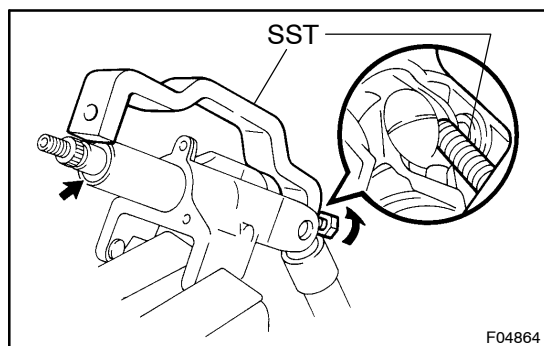
**20. REMOVE MAIN SHAFT ASSEMBLY**

- (a) Using SST, compress the compression spring.
SST 09950-40011 (09958-04010)

NOTICE:

Do not bend the universal joint of the shaft assembly more than 20°.

- (b) Using a snap ring expander, remove the snap ring.
- (c) Remove the shaft assembly from the column upper tube.
- (d) Remove the compression spring and bearing thrust collar from the shaft assembly.